

# V360 Live Streaming Studio (All-In-One V2.0)

## User Manual



### IMPORTANT:

Before using V360 live streaming studio, please read this user manual carefully.

## 目录

1. V360 Operation And Settings.....	- 3 -
1.1 Interface Description.....	- 3 -
1.2 V360 Installation.....	- 4 -
1.3 Settings.....	- 5 -
2. Joy Hub APP.....	- 8 -
2.1 Run the Joy Hub APP.....	- 8 -
2.2 Joy Hub APP interface.....	- 10 -
3. Audio settings.....	- 14 -
3.1 Setting.....	- 14 -
3.2 Input Audio.....	- 15 -
4. V360 Audio Detail Explanation.....	- 15 -
4.1 V360 Audio Category.....	- 15 -
4.2 V360 Input Audio.....	- 16 -
4.3 How to use.....	- 17 -
5. Virtual Studio.....	- 18 -
5.1 Introduce.....	- 18 -
5.2 Green Matting.....	- 19 -
5.3 Blue Matting.....	- 21 -
6. Others Menu Description.....	- 22 -
6.1 Personal Center.....	- 22 -
6.2 Network.....	- 24 -

# 1. V360 Operation And Settings

## 1.1 Interface Description

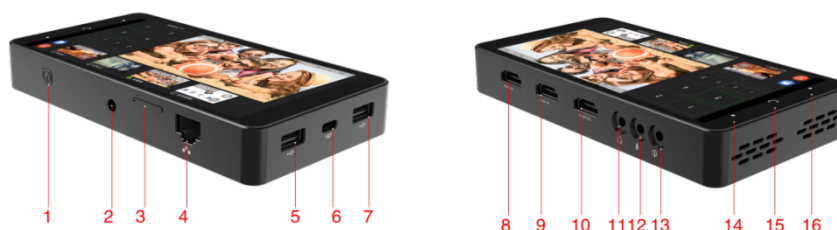

1.1.1 Turn on/ turn off

1.1.2 Hot shoe or tripod bracket connected, etc.

1.1.3 SIM card + SD card tray, do not use mobile phone card as built-in sim card.

To prevent calls from interrupting the live broadcast

1.1.4 RJ45 connected to the wired network ( if the network cable cannot be found, please restart the device)

1.1.5 RJ45 connected to the wired network

1.1.6 USB2.0 port used to plug an external 4G card tray

1.1.7 Type-c input port, 5V3A

1.1.8 HDMI output used for extended display, can be connected to a large screen.

1.1.9 HDMI input 1 used to access HD signal sources, for example cameras.

1.1.10 HDMI input 2 used to access HD signal sources, for example cameras.

1.1.11 Audio output can be looked as a monitor.

- 1.1.12 Microphone input
- 1.1.13 Audio input, access to the mixer.
- 1.1.14 Backstage management;
- 1.1.15 Return the main screen;
- 1.1.16 Back to previous;

The indicator light is red in charging. When the power is less than 20%, the indicator light is also red. The green indicator means you have about 20%-100% power.

## 1.2 V360 Installation

- 1.2.1 SIM card: Insert a medium card into the card tray.
- 1.2.2 SD card: Take a card less than 128G and put it into the built-in card tray, then insert it into the card slot

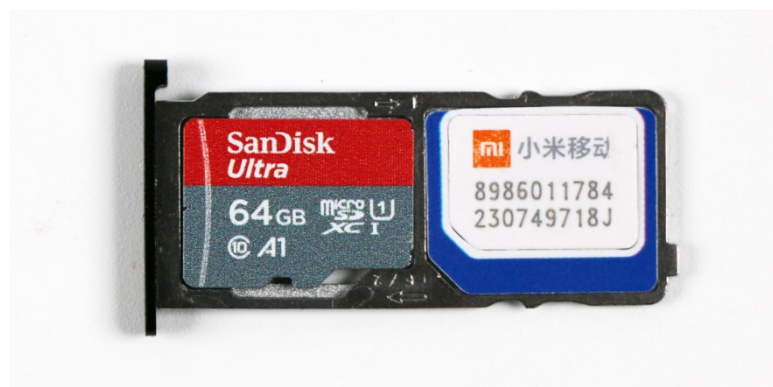

- 1.2.3 PTZ hot shoe: There is a 1/4 screw hole on the device used to fix the V66 on

the tripod. When installing the double-layer hot shoe, fix the screw by a nut.

1.2.4 TYPE-C charging: Output 3A/3.6-8V, 9V/2A;

1.2.5 System switch: Power to turn on or stop the sleep state.

1.2.6 4G card tray: Open the cover and insert the SIM into the USB2.0 port.

## 1.3 Settings

1.3.1 Please put your hand on power switch for 5 seconds to boot up.

1.3.2 Setting the network, Wifi, 4G, or wired

Wifi setting: Setting -- WLAN -- open-- select network and input password

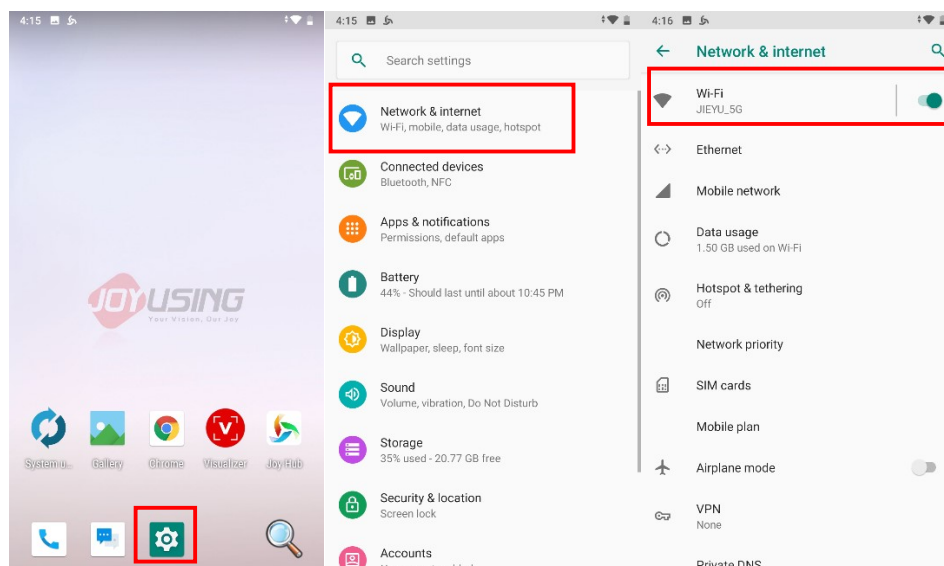

1.3.3 4G setting: Insert the SIM card into the 4G V360 cato, the copper side of SIM card must be faced down and the notch must be faced outwards.

1.3.4 RJ45 Wired network setting:

If you want to connect the RJ45 port to the wired encoder, please connect the encoder first, and then set the steady-state address as follows:

**“Setting” -- “ Network & internet” --“ Ethernet” -- “Ethernet configuration” -- “DHCP” -- “IP address”**

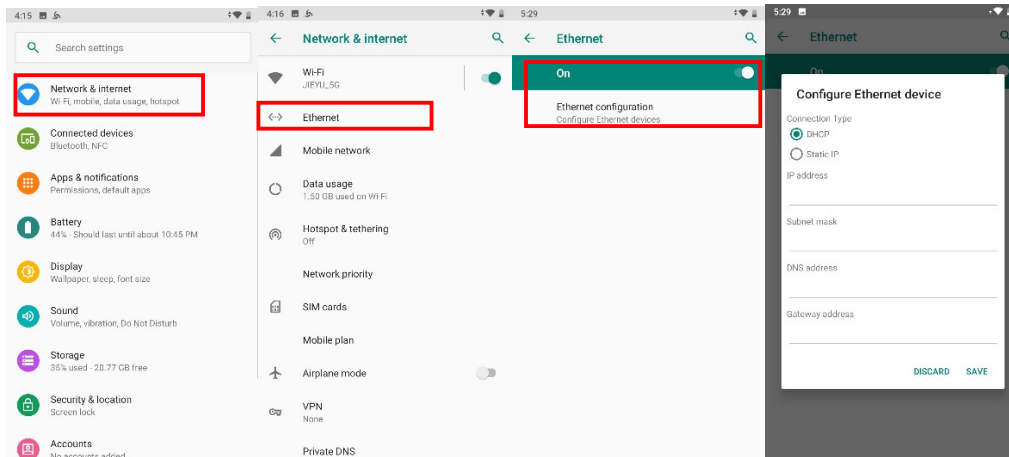

**1.3.5 Hotspot & tethering: “Settings” -- “Network & internet” -- “ Hotspot & tethering” -- “Wi-Fi hotspot” -- “Hotspot name” and “Hotspot password”**

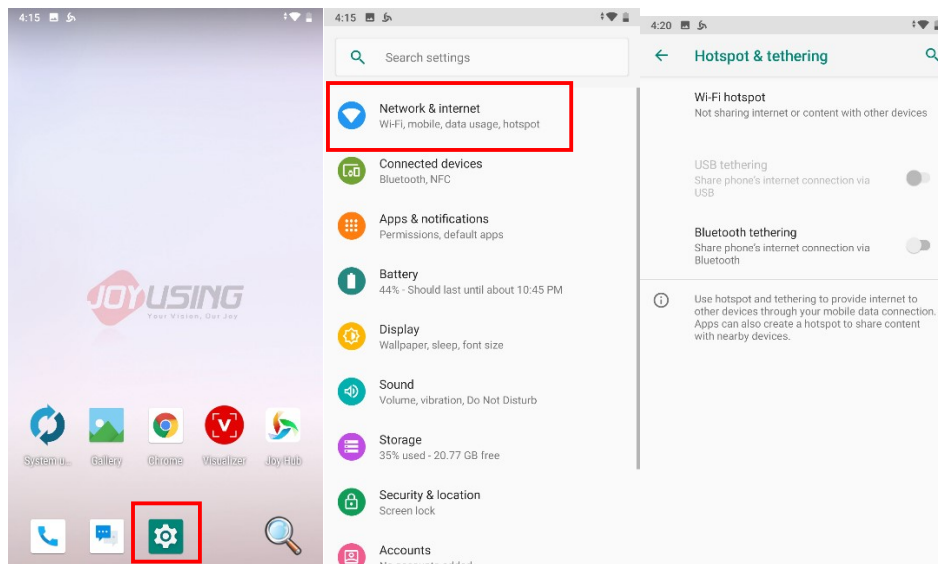

**1.3.6 System upgrade and APP upgrade**

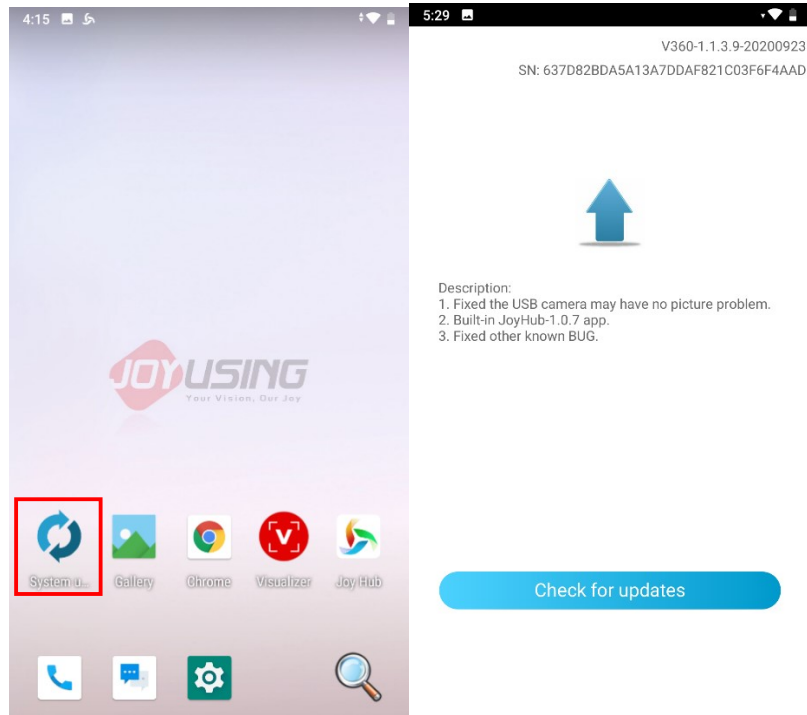

Note: V360 Upgrade management is available, please initialize the system after the upgrade.

Initialization operation: **“Setting” -- “System-Reset options” --“ Erase all data” (factory reset)**

Joy Hub: Joyusing’ s broadcast live APP

### 1.3.7 Optional Network Priority

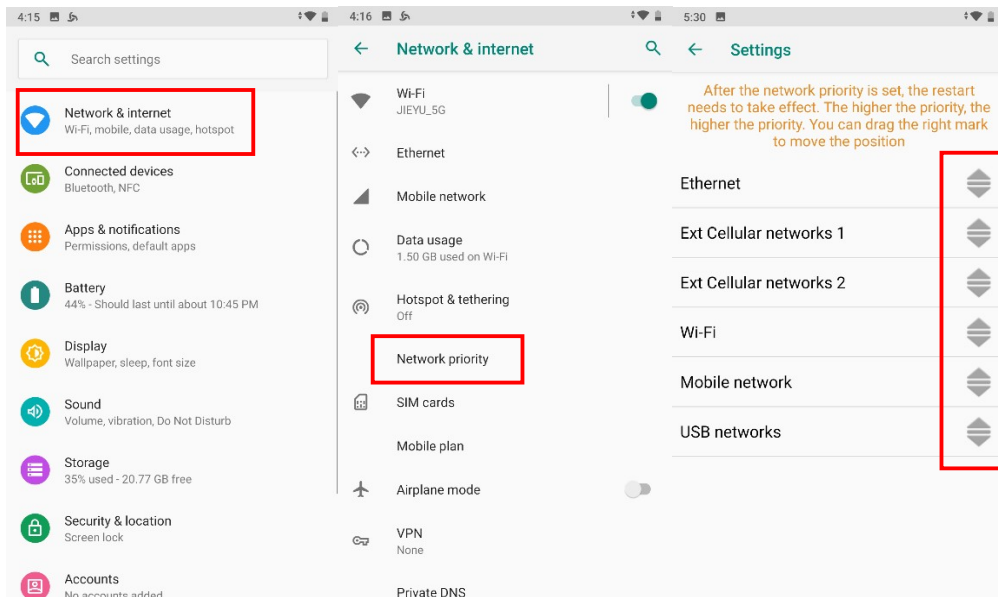

**“Setting” --Network & internet” --” Network priority” --” Ethernet” , “Ext Cellular networks 1” , “Ext Cellular networks 2” , “Wi-Fi” , “Mobile network” , “USB networks” for your choose.**

## 2. Joy Hub APP

### 2.1 Run the Joy Hub APP

2.1.1, Register an account: when you use joyusing products for the first time, open the JOY guide APP and click on : “Me” --” Login” -- “REGISTER”

Shown as:



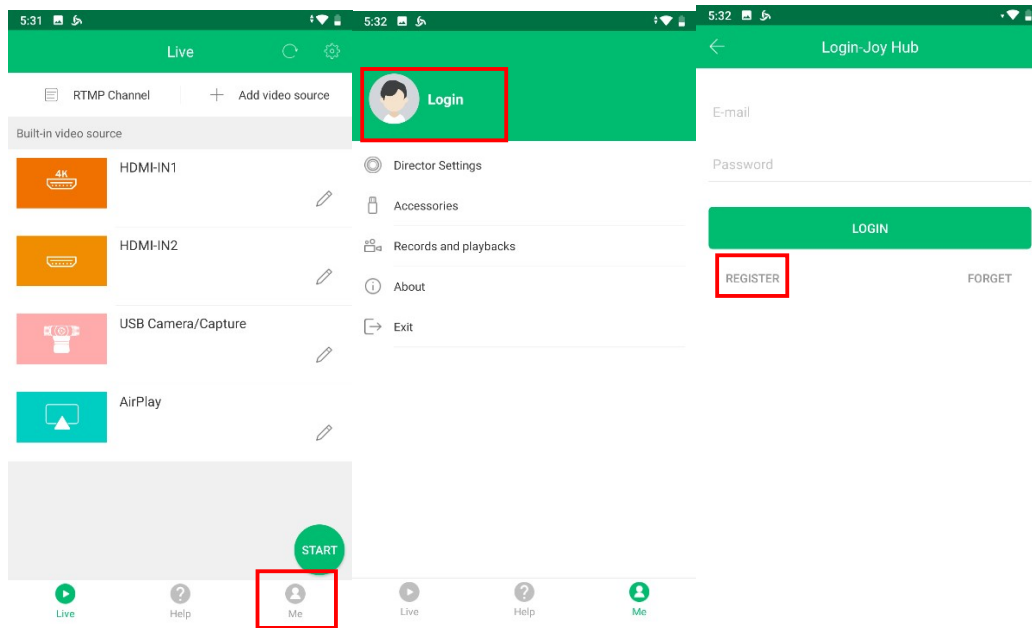

If you already have an account, you can log in directly.

### 2.1.2, Click on "Joy Hub" -- " START"

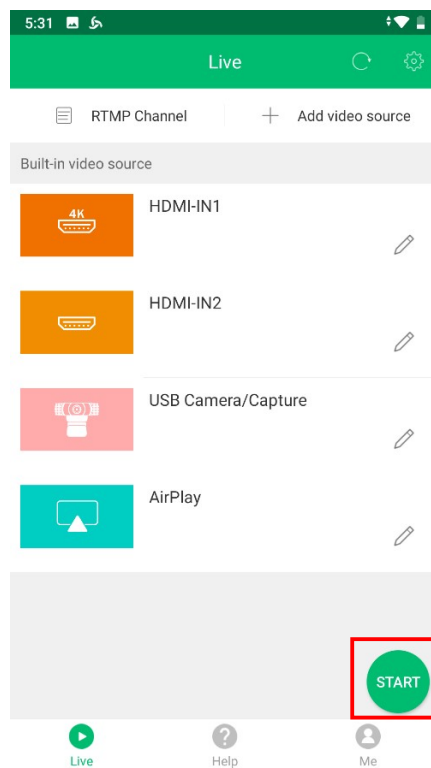

## 2.2 Joy Hub APP interface

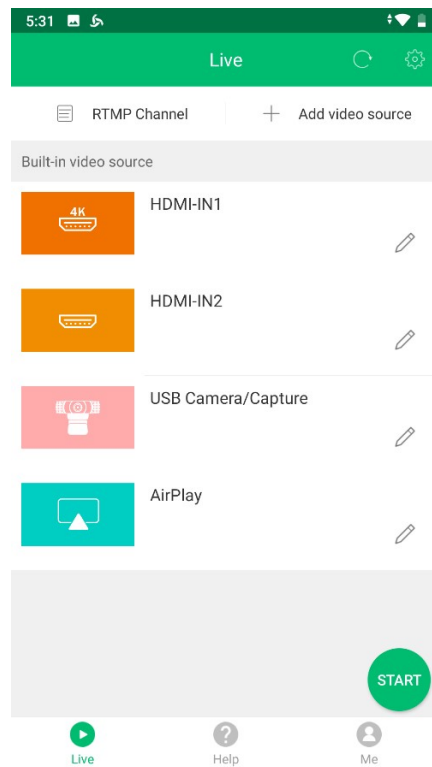

2.2.1 Click on the “START ” button , enter the “Play” page, fill in the “RTMP Publish URL” and set the parameters, including “Encoding” , “Output bitrate” , and “ Out resolution” . Note: Only H265 encoding can be supported at 4k resolution.

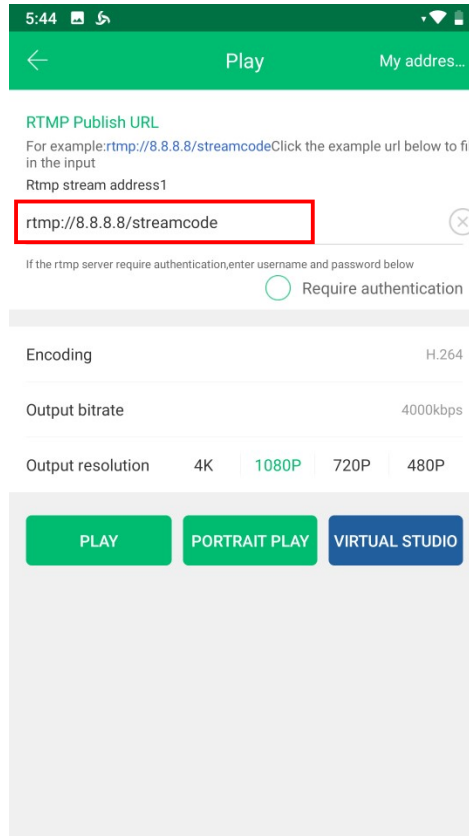

Click on the "Play" button in the lower left corner to enter the interface.

## 2.2.2 Add an address book to the website

Before using V360, please open the website: [http:// a.hemiaotv.com](http://a.hemiaotv.com) and save your RTMP Publish URL for using next time. (Please log in it with your registered email)

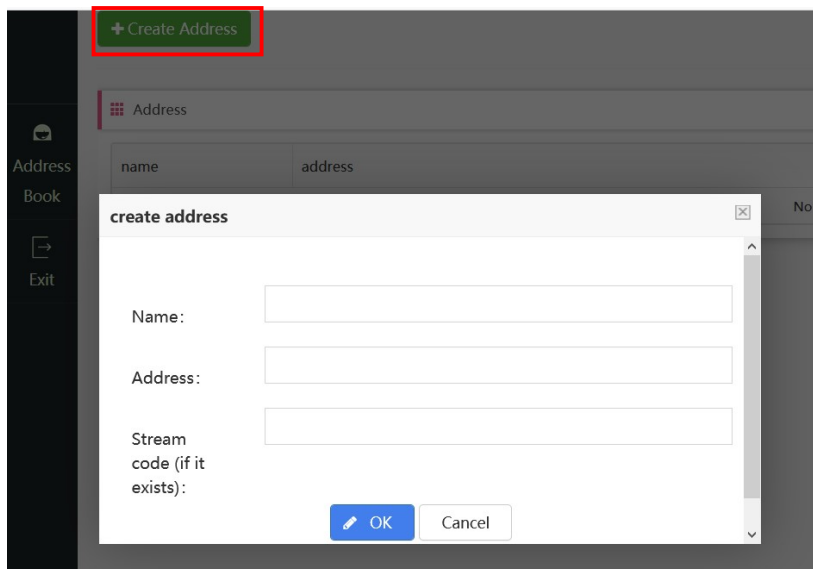
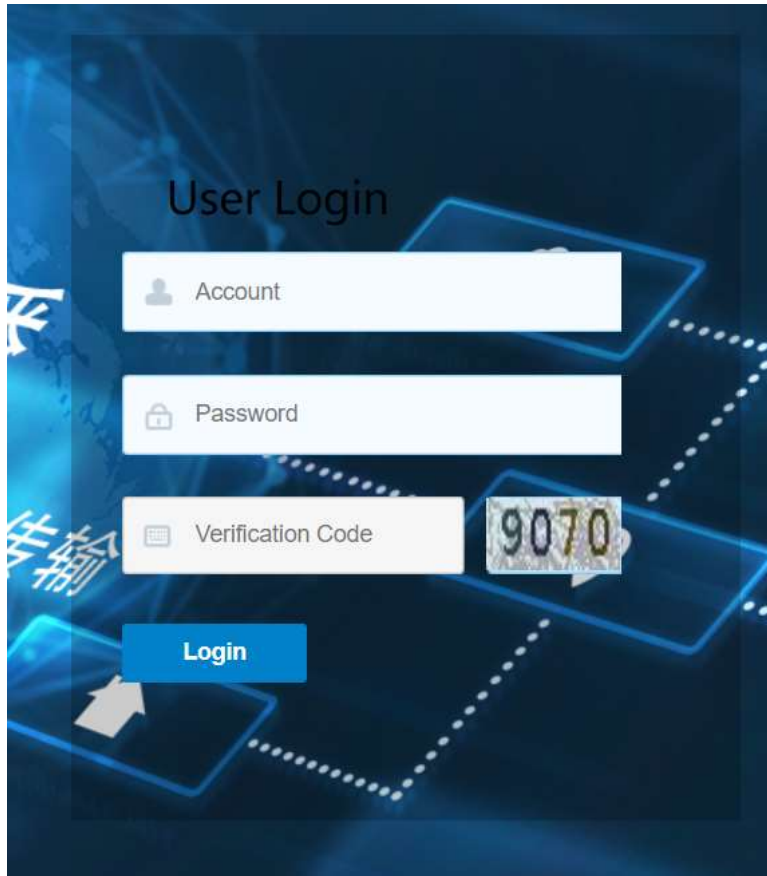

2.2.3 Add an address by selecting the right top corner "My address"

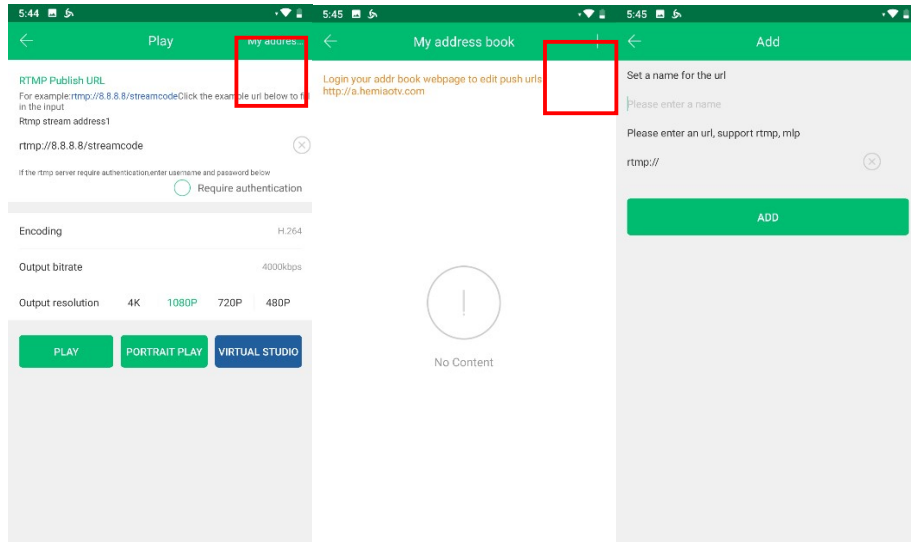

## 2.2.4 Output bitrate

Manually set the output bitrate during live streaming according to your network bandwidth and required video resolution.

Eg: 2000kbps=2M (standard) 4000kbps=4M (HD bit rate)

## 2.2.5 Output resolution

When 4K resolution is selected, there is only 1 slot left.

## 2.2.6 Enter the Joy Hub interface

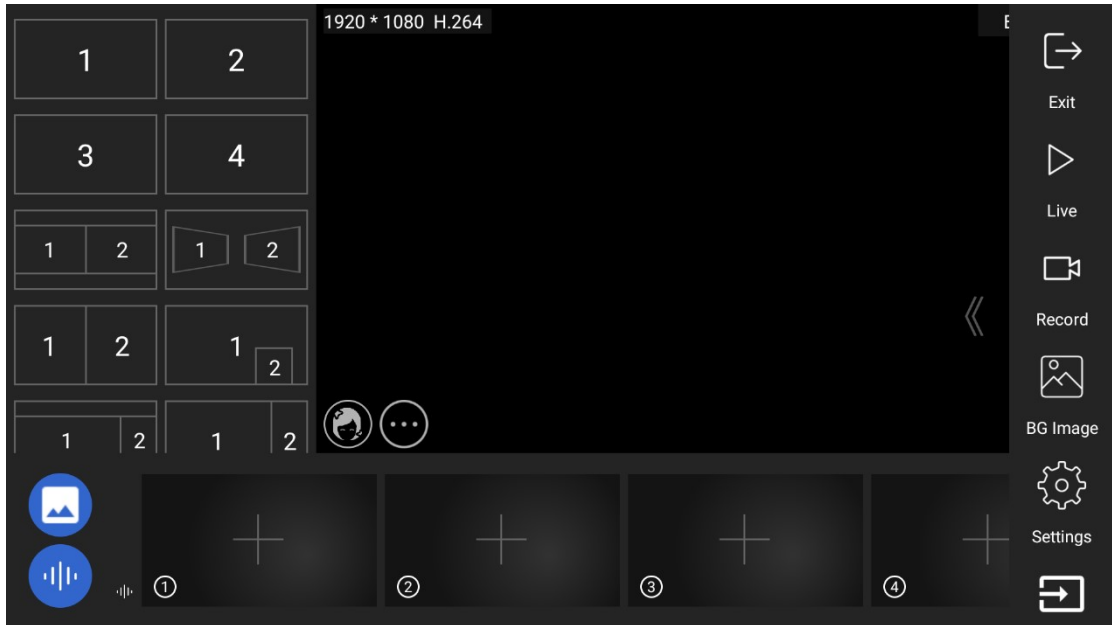

### 3. Audio settings

#### 3.1 Setting

Click on the lower left blue button to set up

The audio is locked and can not be changed along with the video switch.

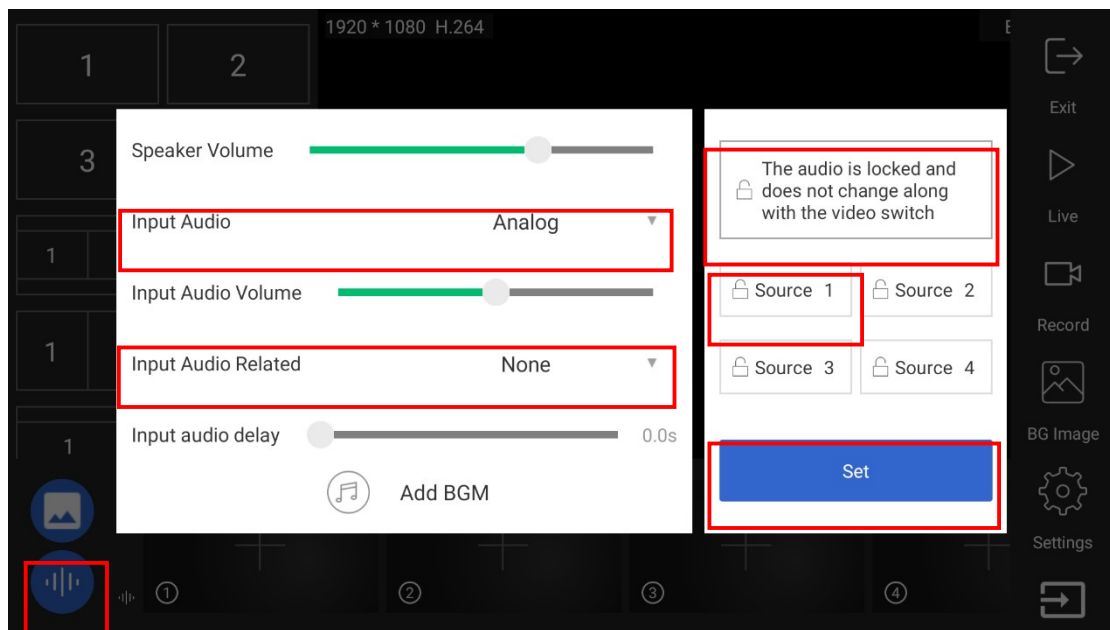

## 3.2 Input Audio

3.2.1 Select "Nothing" : No audio

3.2.2 Select "Analog" : Output external sound from 3.5 audio or external headphone and microphone sound.

3.2.3 Select "HDMI1" : Output HDMIin1 sound

3.2.4 Select "HDMI2" : Output HDMIin2 sound

3.2.5 Select "USB" : Output USB capture card or USB camera sound

Only one external audio is available. If you want to switch between external audio and local sound, you need to associate additional external audio signals.

## 4. V360 Audio Detail Explanation

### 4.1 V360 Audio Category

4.1.1 Analog: Output external 3.5 audio sound or external headphone and microphone sound.

4.1.2 Data: HDMI audio is based on USB that receive audio signals.

4.1.3 Media: Including MP4 video files, network streaming video, built-in recording files.

## 4.2 V360 Input Audio

4.2.1 HDMI IN1 means input data audio. If you want to pick up an audio signal when using a camera microphone, please input the HDMI bit to access the HDMI IN1 in V360.

4.2.2 HDMI IN2 means input data audio. If you want to pick up an audio signal when using a camera microphone, please input the HDMI bit to access the HDMI IN2 in V360.

4.2.3 3.5 audio line input : Analog audio input can be connected to mixer, computer, mobile phone, PS4 and other headphones output. Please note that the audio equipment volume must be controlled at less than 50% to prevent explosions.

4.2.4 Microphone input: Analog audio input can be connected to headphones for desktop computers.

Note: Because of built-in mics., you' d better plug in the headset when you are using the microphone in case of howling.

4.2.5 Headphones for computers: Earphones separated





4.2.6 Mobile headset works with the following conversion lines:



## 4.3 How to use

4.3.1 HDMI audio: when you use a camera or switch station to output HDMI signal with audio signal, please insert the HDMI cable into the HDMI IN1 and then input audio in the audio menu bar, just select: HDMI 1.

If you want to switch or lock the audio from other video source, please

associate the corresponding video source.

The jump of standard microphone symbol in the lower left corner indicates that there is a sound being output.

Microphone or line audio: Please insert the microphone or line audio into the device (either option),and then input audio in the audio menu bar, just select: analog. If you want to switch or lock the audio from other video source, please associate the corresponding video source.

4.3.2 USB Camera / Extension 2 Generation: Select USB Device Option for this audio

If it is the third party APP, please select "HDMI"

4.3.3 Audio of other video files: When you add various video files and stream video files, the sound will be played out. You can use audio locking to select one of the audio signals and change the volume in the preview.

## 5. Virtual Studio

### 5.1 Introduce

V360 live streaming studio creatively makes blue & green matting and virtual studio functions on handheld devices come true, contributing to your live broadcasting more professional.

Click on virtual studio - enter the virtual studio interface

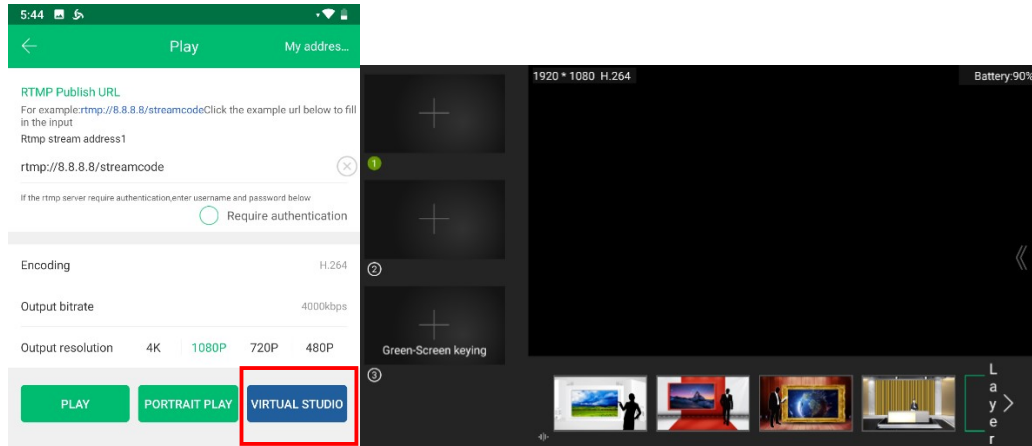

## 5.2 Green Matting

### 5.2.1 Select the matting object

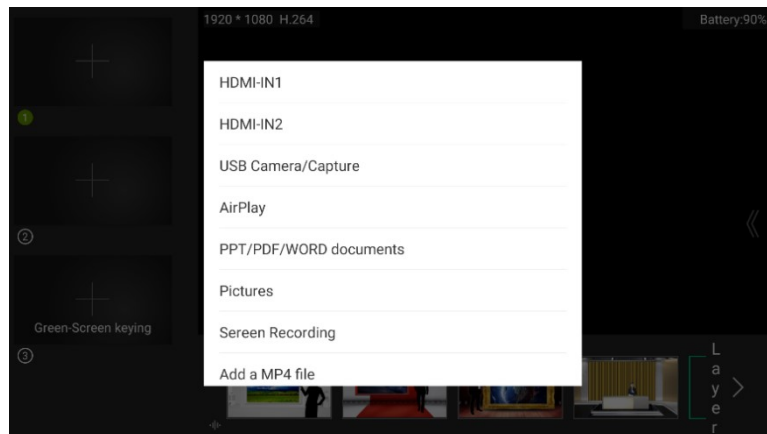

### 5.2.2 Click on the "KEYING"

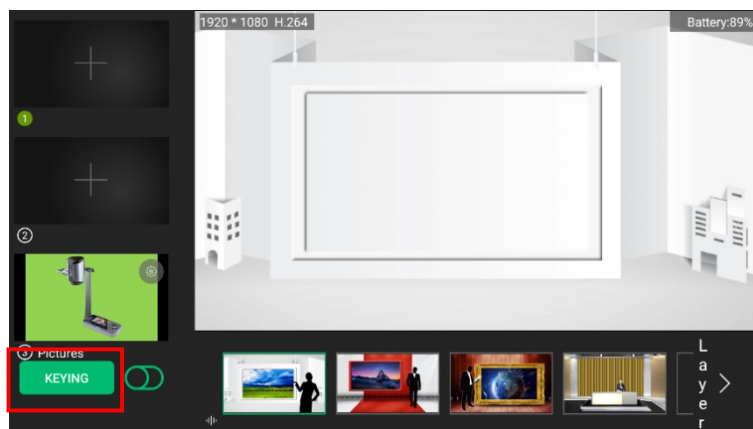

### 5.2.3 Adjust the border of the image, select "Filter Color", and then click on

"NEXT"

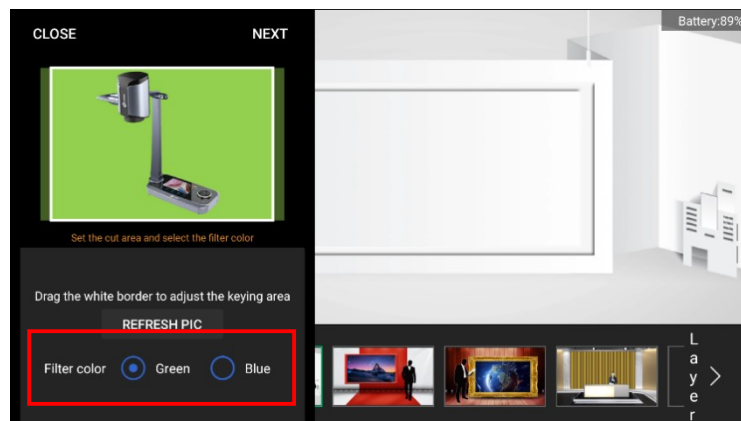

#### 5.2.4 Adjust image position and set matting parameters (Similarity and Blend)

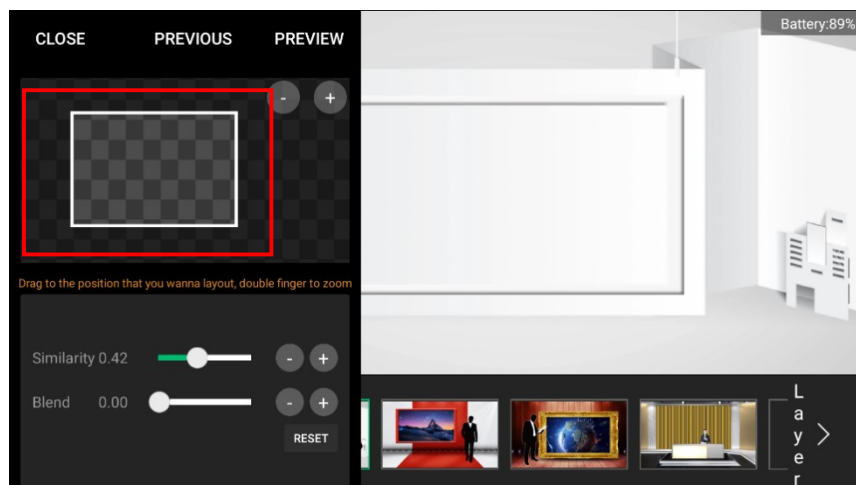

#### 5.2.5 Preview

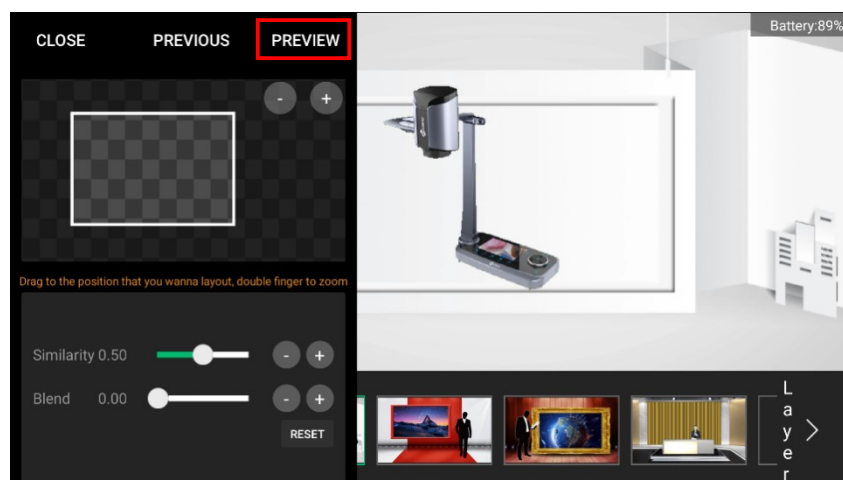

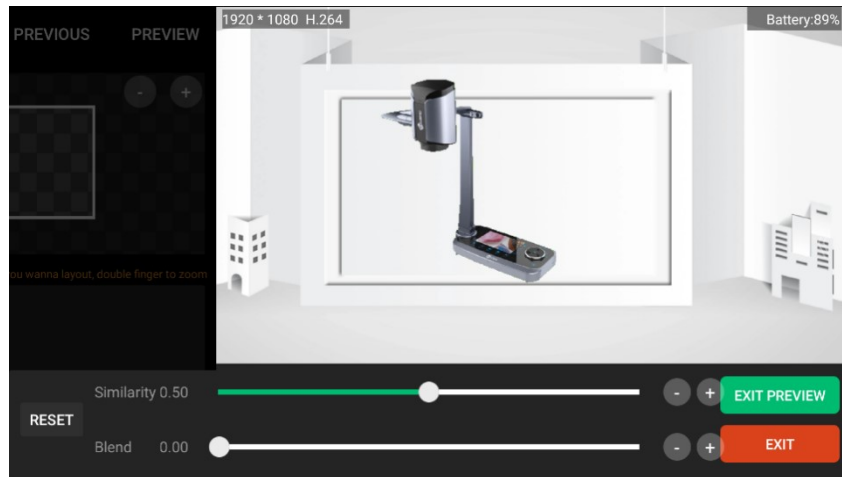

## 5.2.6 Rendering

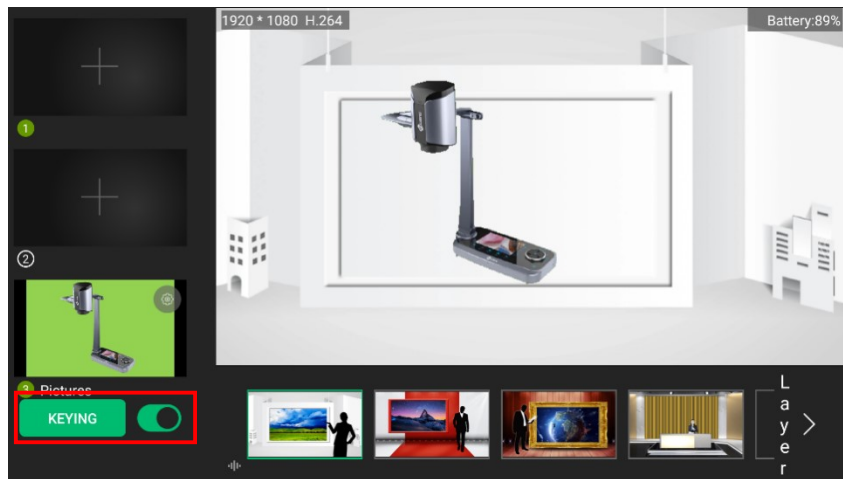

## 5.3 Blue Matting

5.3.1 The operation process is the same as green matting

5.3.2 Select the object

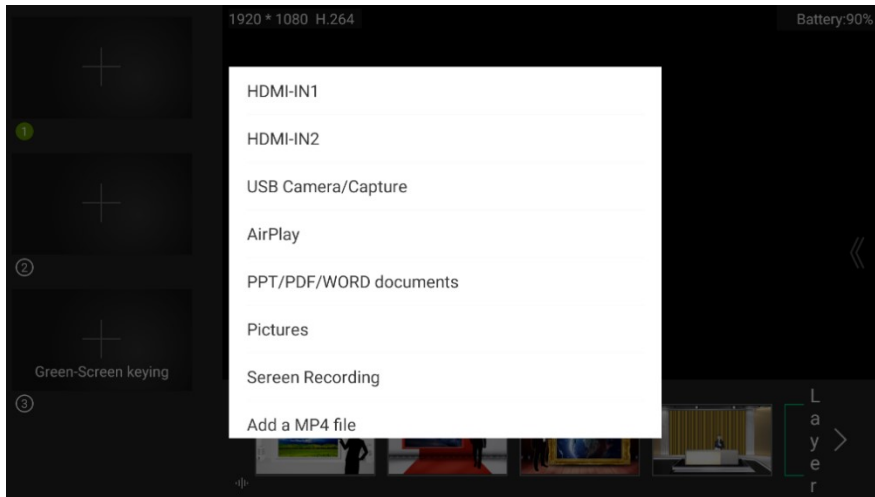

### 5.3.3 confirm matting

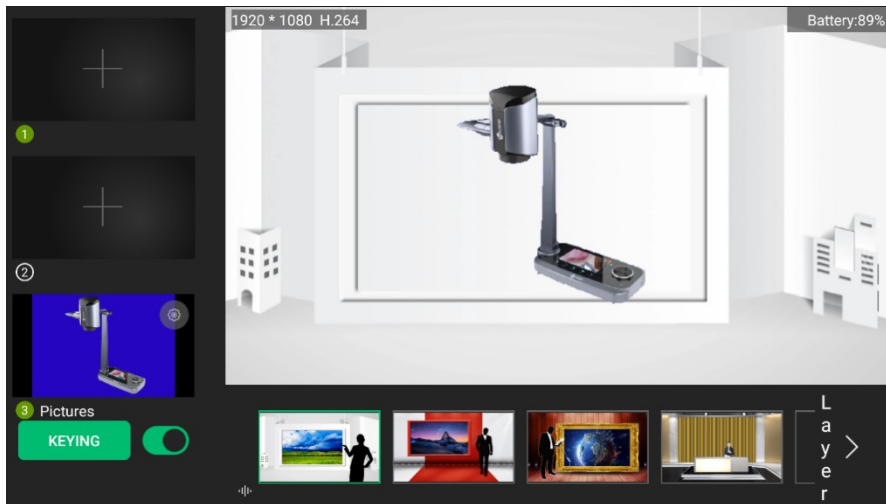

## 6. Others Menu Description

### 6.1 Personal Center

#### 6.1.1 Click on the button "Me"

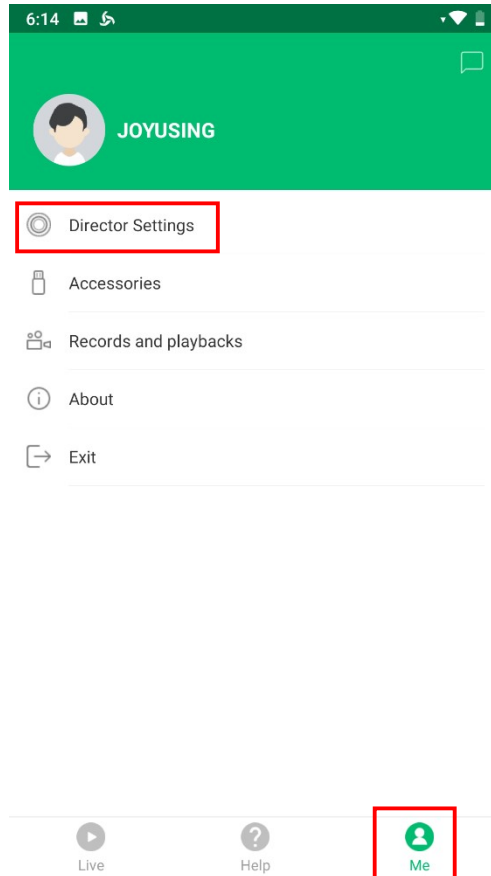

6.1.2 Director settings is used for setting the output operation, shown as follows:

Set the video output orientation, bitrate and resolution, storage alarm value, etc. (please click the blue "Modify" )

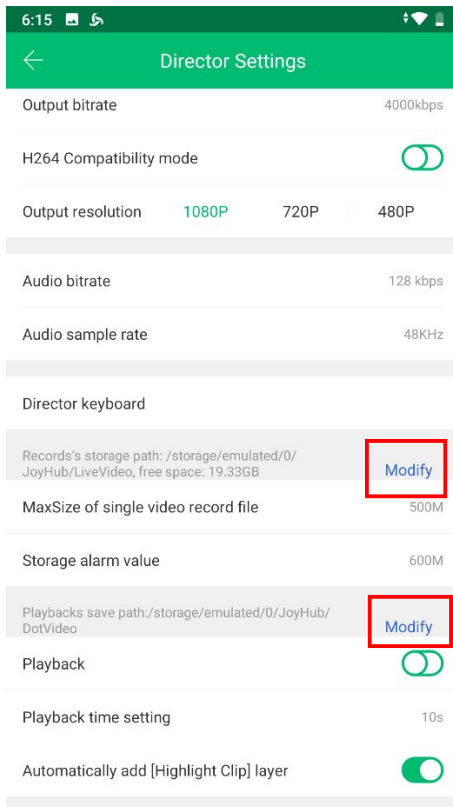

## 6.2 Network

### 6.2.1 Support Network

Support Network	<p>◆1 x built-in module, support mode: TDD-LTE、 FDD-LTE、 WCDMA</p> <p>China / India : LTE FDD: B1/B3/B5/B8 ; LTE TDD: B34/B38/B39/B40/B41 WCDMA: B1/B8 ; TD-SCDMA: B34/B39</p> <p>EVDO/CDMA: BC0 GSM: B3/B8</p>
-----------------	---



	<ul style="list-style-type: none"> <li>◆2 x built-in module, support mode: TDD-LTE、 FDD-LTE、 WCDMA (Optional)</li> <li>◆1 x WIFI built-in module: IEEE 802.11a/n/g/b 2.4G+5G</li> <li>◆1 x Ethernet 10M/100M: Local network port</li> </ul>
--	---

### 6.2.2 Input:

Input video	Input interface: HDMI IN:HDMI1(Main), HDMI2 (secondary)
	<p>Support interlaced and line-by-line resolution, such as 3840*2160,1920*1080,1600*900,1440*900,1440*1050,1366*768,1360*768,1280*1024,1280*960,1280*800,1280*720,1280*600,1024*768,800*600, etc.</p> <ul style="list-style-type: none"> <li>◆Secondary HDMI supports resolution, 1920*1080P , 720P</li> </ul>
Audio	<p>Digital audio: Main HDMI input</p> <p>Simulate audio: MIC input and line audio input</p> <p>Digital audio and simulate audio can be switched freely.</p>

### 6.2.3 Live streaming Output

Video	<p>Video coding method:H264, H265</p> <p>Video coding frame rate: 25/30HZ</p> <p>Director resolution: 4K / 1080P /720P. (4K resolution must come with H265.</p>
-------	---

	Output bitrate: Dynamical and adjustable
Audio	Audio coding: aac Audio bitrate default is 96 Optional: 64kbps,96kbps,128kbps,160kbps,192kbps,256kbps Audio sample rate: 48KHz,44.1KHz

#### 6.2.4 System

Operation system	Android 9.1
Network	RJ45: 100M port WIFI: 2.4G+5.8G 4G+:Max. 300M
Screen	6" &1080P touch screen
Internal storage	3G RAM + 32G ROM
Upgrade	Software upgrades can be carried out according to network.

#### 6.2.5 Interface

USB	1* TYPE-C*USB2.0
SD card	Max. 128G
SIM card	Medium card

## 6.2.6 General

Size	Package size: (wide x long x high)220*150*70mm
V360 size	Wide: 86mm Thickness: 23mm Long: 165mm
Weight	0.35KG/piece Package weight: 0.4KG
Temperature range	0~45°C (working) -20~80°C (storage)
Power	Battery powered, Charging voltage 3.6-8V/3A, 12V/2A
Power consumption	Battery capacity: 8000mAh(18W)